

Please review these instructions carefully before proceeding.

1

Align the picture wall in place. Anchor it by placing masking tape in each of the top corners as shown.

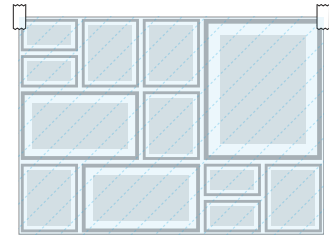

2

Measure the centre of the decal and place two vertical strips of masking tape at the centre point, securing the picture wall further.

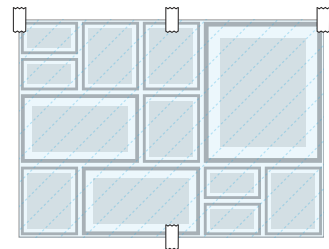

3

Remove the masking tape at the left hand corner of the picture wall. Slowly peel away the backing paper and cut off the excess as shown.

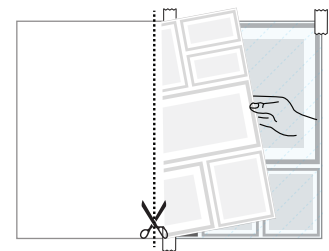

4

Ensure the picture wall is held away from the surface by the application tape.

With a squeegee in hand, begin squeegeeing the picture wall, starting from the centre point. Use short strokes, applying a little bit of the graphic at a time.

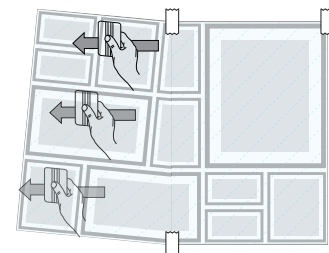

5

Once the left hand side of the picture wall is secure, remove the remaining masking tape and repeat steps three and four with the right hand side of the graphic.

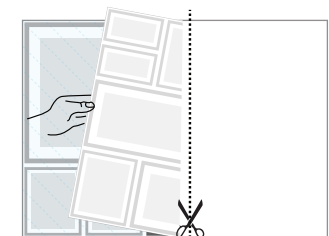

6

Once the entire graphic is adhered to the wall, remove the application tape by carefully peeling it back on itself as shown.

DO NOT pull at a 90° angle.

